

PHILIPS

HD 7105

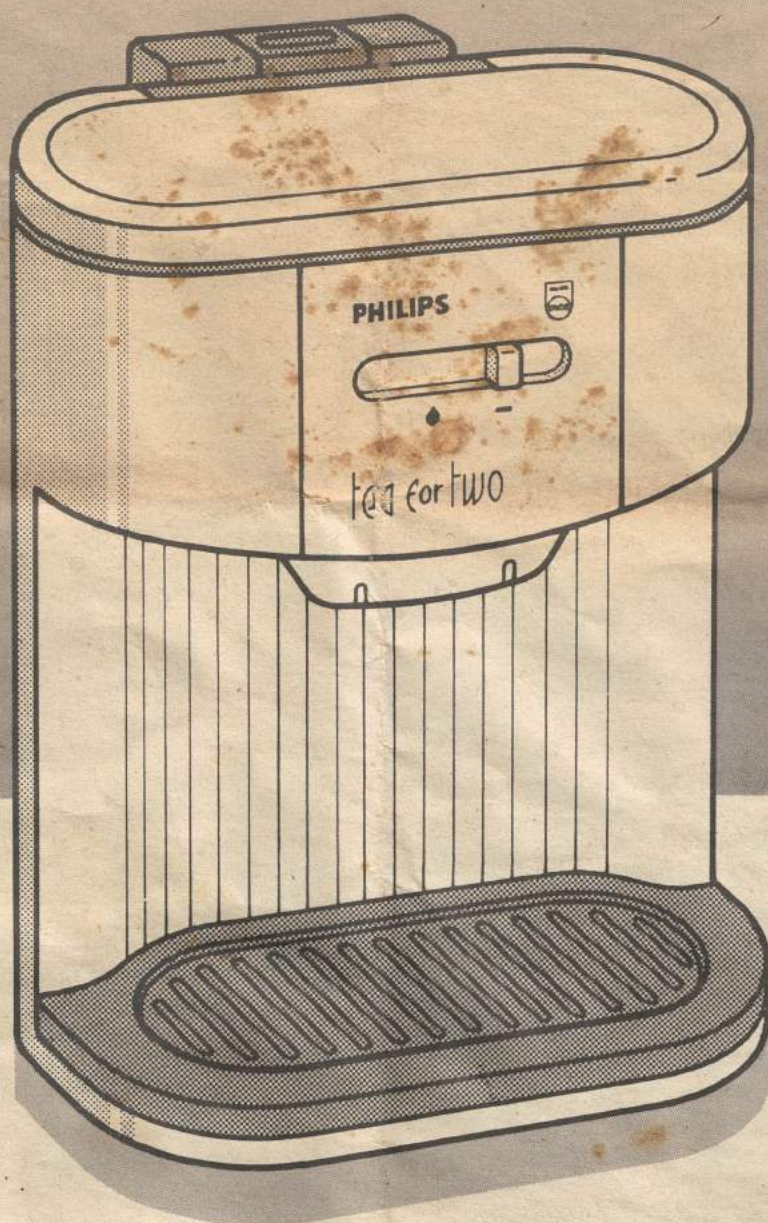

PHILIPS



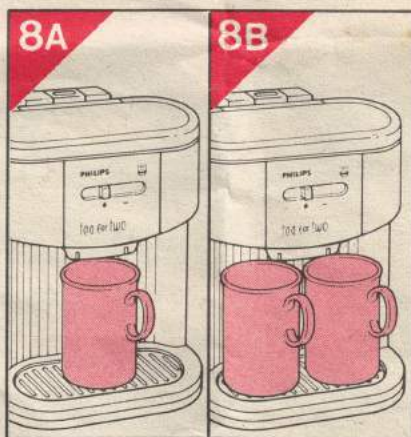
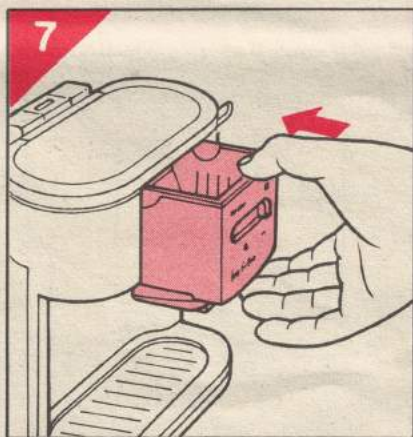
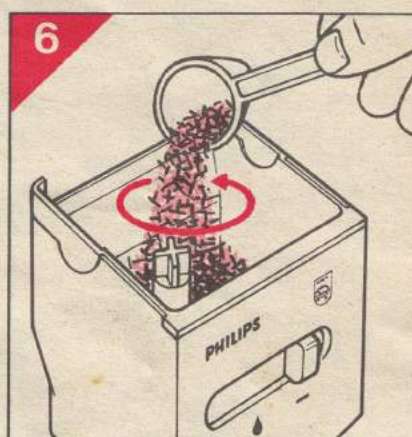
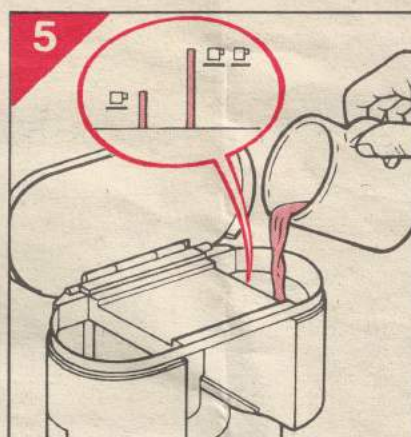
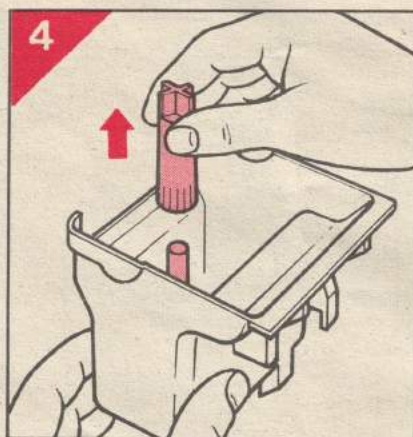
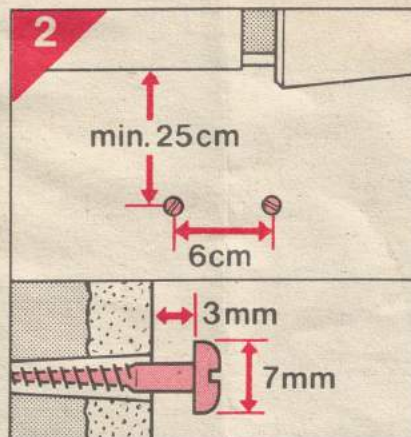
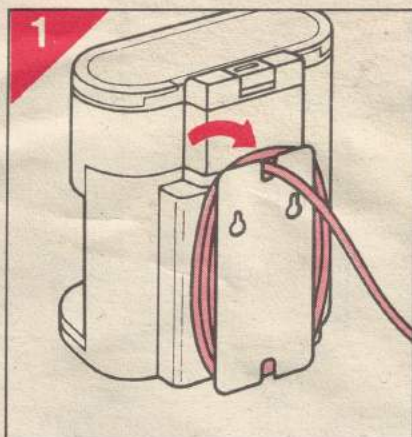

English

Cord storage (fig. 1)

You can keep excess mains cord rolled up around the back plate.

Wall mounting (fig. 2)

The appliance can be wall mounted or free standing.

When wall mounted allow ample space above the appliance for filling with water! The distance between the centres of the two drilling holes must be 6 cm (2.35"). (See the drilling template on the flap of the packaging.)

Anti-drip lever

- Always set the anti-drip lever to the **left-hand** position (symbol "▲") before switching on.
- Always set the anti-drip lever to the **right-hand** position (symbol "-") before removing the cup(s) or mug(s) from the appliance.

Automatic switch-off

The appliance switches off automatically. If the pilot light comes on when inserting the mains plug into the wall socket, just wait for it to go out. After that, let the appliance cool down for three minutes before switching on.

Before first use

Operate the appliance twice before filling the filter. (See section "Making tea".) Next, clean the removable items. (See section "Cleaning".)

Cleaning

- Always remove the plug from the mains outlet before cleaning the appliance.
- Never immerse the appliance in water. You can clean it with a damp cloth.
- The removable items (including the drip-tray, fig. 12) can be washed in hot soapy water (or in a dishwasher). Rinse with clean hot water and dry.
- The tea filter can only be removed from the filter holder or replaced after setting the anti-drip lever to the left position (fig. 3).
- The outer pipe of the syphon can be removed from the inner pipe (fig. 4). (Do not mislay the outer pipe!)
Press the outer pipe firmly in place when replacing.

Making tea (figs. 5-11)

- Fill the water tank with the required quantity of fresh cold water (fig. 5).
The left hand side level indications correspond to large cups (1.25 dl or 0.22 pint). The right hand side level indications correspond to small cups (1 dl or 0.18 pint).
Ensure that the water level is no higher than the

maximum marking in the water tank.

- Set the anti-drip lever to the right-hand position (symbol "-"). Then remove the tea filter from the appliance (fig. 3).
- Put the tea into the tea filter. Generally, one level measuring spoonful of tea (fig. 6).
Distribute the tea evenly. Alternatively, you can use a tea bag.
- Place the tea filter into the appliance (fig. 7).
- Position one or two cup(s) under the water outlet openings (figs. 8A and 8B).
- Set the anti-drip lever to the left-hand position (symbol "▲") (fig. 9).
- Press the button to switch on (fig. 10). The pilot light comes on.
- After the pilot light has gone out, wait for the last of the tea to drip into the cup(s). Please note that the tea does not keep warm!
- Do not forget to set the anti-drip lever to the right-hand position (symbol "-") before removing the cup(s) (fig. 11).
- If you have made tea and wish to make some more rightaway, first empty and rinse the nylon filter.
Allow about three minutes for the appliance to cool down. You may then fill the water tank again.

Descaling

Descal your appliance regularly. With normal use:

- hardness **up to 18° DH - 2 or 3 times a year**
- hardness **over 18° DH - 4 or 5 times a year.**
Your water supply company can inform you about the hardness of your water.
- Operate the appliance two or three times as indicated in section "Making tea". However, now use ordinary vinegar to fill the water tank and do not fill the tea filter with tea. (You can use the same vinegar twice.)
- After descaling, let the appliance work twice more with only water to rinse away the vinegar and scale remainders.
- Wash the removable items.

Replacing the mains cord

If the mains cord of this appliance is damaged, it must be replaced by the special cord.
Apply to your Philips dealer or to the Philips organization in your country.

Products bought in Canada

For guarantee conditions on products bought in Canada see separate purchase card.

IMPORTANT
Connections - Applicable to U.K. only

WARNING

THIS APPLIANCE MUST BE EARTHED

The wires in this mains lead are coloured in accordance with the following code:

GREEN AND YELLOW-EARTH.
BLUE-NEUTRAL
BROWN-LIVE

As the colours of the wires in the mains lead of this appliance may not correspond with the coloured markings identifying the terminals in your plug, proceed as follows:

The wire which is coloured **GREEN AND YELLOW** must be connected to the terminal which is marked with the letter "E" or by the earth symbol \perp or coloured **GREEN** or **GREEN AND YELLOW**.

The wire which is coloured **BROWN** must be connected to the terminal which is marked with the letter "L" or coloured **RED**.

The wire which is coloured **BLUE** must be connected to the terminal which is marked with a letter "N" or coloured **BLACK**.

If a BS 1363 13A plug is used this must be fitted with a 13A fuse.



